



H450

HISTORICAL ALUMINUM SERIES

Casement | Project-Out | Fixed









 **Product Material**
Aluminum

 **Frame Depth**
3 1/4"

 **Rating**
Casement: Up to CW90
Project-Out: Up to CW90
Fixed: Up to AW100

565 Hank
Atlanta, GA
Developer: Carter Developments
Architect: Rule Joy Trammell Rubio, LLC
Contractor: New South Construction
Commercial Window Dealer: Williams Bldg. Products



 Design Pressure Casement: Up to 90 Project-Out: Up to 90 Fixed: Up to 100	 U-Value* Casement: 0.30-0.39 Project-Out: 0.31-0.39 Fixed: 0.23-0.34
 Air Infiltration Casement: <.30 Project-Out: <.30 Fixed: <.10	 SHGC* Casement: 0.14-0.31 Project-Out: 0.14-0.31 Fixed: 0.16-0.37
 Water Resistance Casement: Up to 15 Project-Out: Up to 15 Fixed: Up to 15	 CR* Casement: 43-58 Project-Out: 41-57 Fixed: 47-69
 OITC# Casement: 29-32 Project-Out: Fixed:	 STC# Casement: 34-37 Project-Out: Fixed:

*- U-Value and SHGC ranges are NFRC certified and based on I.G. combinations incorporating some or all the following: Low-E glass, clear glass, argon gas and/or air fill, and grids
- Ranges based on multiple I.G. combinations
All ratings listed are NAFS certified. Periodic re-certification testing is required thus data shown may vary slightly.

FEATURES:

- ▶ Historically-correct bevel frame
- ▶ Steel Replica appearance
- ▶ Thermally-broken frame & sash
- ▶ Casement and Project-out operating models
- ▶ Matching Fixed model
- ▶ Architectural grade aluminum frame
- ▶ Thermally-broken frame and sash
- ▶ 2 5/16" narrow sidelines on operable units, and 1 1/2" on fixed
- ▶ With or without Integral Nailing Fin
- ▶ 1" insulating glass
- ▶ Exterior glazed
- ▶ Integral anchor leg
- ▶ Standard High-Performance 2604 Powder Paint Finish (an FGIA Specification). Optional upgrade to 2605 Finish (an FGIA Specification)
- ▶ 30+ "Quick-Pick" colors, with unlimited custom colors available.
- ▶ Impact rated versions (H470 Series): Project-Out model w/cam handle and Fixed model

www.QuakerCommercialWindows.com

Information listed is deemed accurate as of date shown. Quaker Windows reserves the right to change or discontinue any product, feature or option without notice.

October, 2025 V15a



H450

HISTORICAL ALUMINUM SERIES

Casement Roto

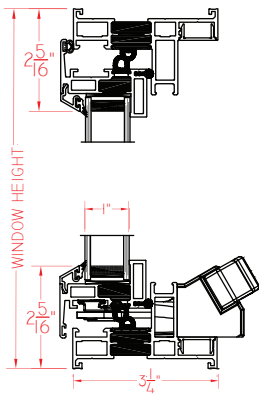

Casement Push-Out

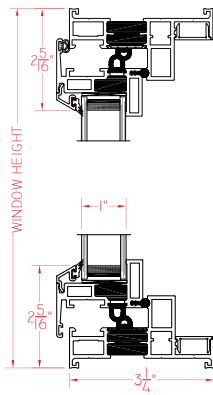

Fixed

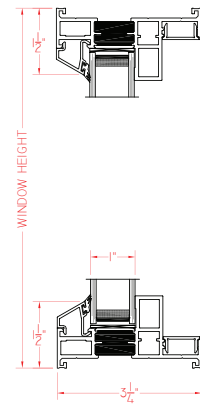

Project-Out Roto

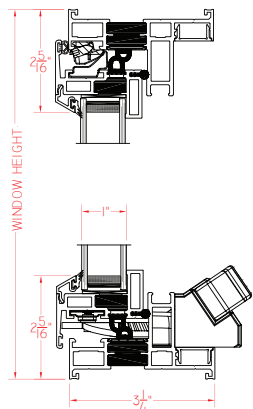

Project-Out Push-Out

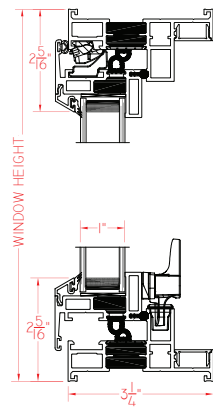

Floating Operator

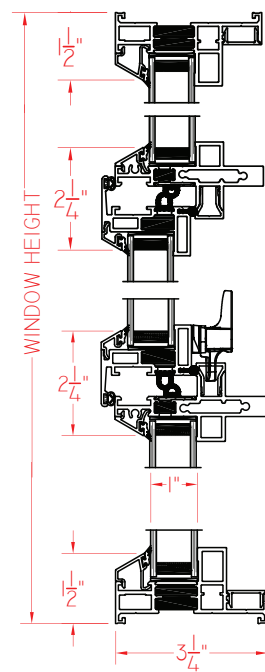

Duffey Lofts
Minneapolis, MN
Developer: CEDARst
Contractor: RJM Construction
Architect: BKV Architects
Glazing Contractor: S & J Glass



QuakerCommercialWindows.com
1-800-347-0438
Commercial@quakerwindows.com